

GENERAL

- THESE DRAWINGS SHALL BE READ IN CONJUNCTION WITH ALL OTHER CONSULTANT'S DRAWINGS AND SPECIFICATIONS. ALL DISCREPANCIES SHALL BE REFERRED TO THE ENGINEER BEFORE PROCEEDING WITH THE WORK.
- ALL DIMENSIONS RELEVANT TO SETTING OUT AND OFF-SITE WORK SHALL BE VERIFIED BY THE CONTRACTOR BEFORE CONSTRUCTION IS COMMENCED. THE ENGINEER'S DRAWINGS SHALL NOT BE SCALED.
- DURING CONSTRUCTION, THE CONTRACTOR SHALL BE RESPONSIBLE FOR MAINTAINING THE STRUCTURE IN A STABLE CONDITION AND ENSURING NO PART SHALL BE OVERSTRESSED UNDER CONSTRUCTION ACTIVITIES.
- WORKMANSHIP AND MATERIALS ARE TO BE IN ACCORDANCE WITH THE RELEVANT AND CURRENT AUSTRALIAN STANDARDS INCLUDING ALL AMENDMENTS AND STATUTORY REQUIREMENTS, EXCEPT WHERE VARIED BY THE CONTRACT DOCUMENTS.
- ALL DIMENSIONS ARE IN MILLIMETRES UNLESS NOTED OTHERWISE.
- DESIGN WIND LOADS ARE IN ACCORDANCE WITH AS1170.2:2001 AS FOLLOWS:
 

RETURN PERIOD	500 YEARS
REGION:	A
TERRAIN CATEGORY	2
WIND SPEED SHIELDING	1.0
TOPOGRAPHIC FACTOR	1.0
LIMIT STATE WIND VELOCITY (Vu)	41.8m/s
AS4055 WIND CATEGORY	N3
INT'L PRESSURE COEFFICIENT	+0.7/-0.5
- DESIGN LIVE LOADINGS ARE IN ACCORDANCE WITH AS/NZS1170.1:2002 AS FOLLOWS:
 

DECK	3.0 kPa
------	---------
- ALL ITEMS CALLED UP BY A TRADE NAME MAY BE SUBSTITUTED BY AN EQUIVALENT ITEM WITH SIMILAR PROPERTIES, SUBJECT TO THE ENGINEER'S WRITTEN APPROVAL.

SITE PREPARATION AND FOUNDATIONS

- THE CONTRACTOR SHALL CHECK ALL FOOTING EXCAVATIONS FOR ORGANIC MATERIAL AND RUBBISH. IF ANY OF THIS MATERIAL IS FOUND, IT SHALL BE REMOVED AND THE EXCAVATION BACKFILLED WITH CLEAN GRANULAR FILL.
- IF DISTURBED, THE BOTTOM OF THE EXCAVATIONS SHALL BE COMPACTED TO A RELATIVE DRY DENSITY OF 100% AS DETERMINED IN ACCORDANCE WITH AS1289-E4.1 AND E1.1.
- THE FOOTINGS HAVE BEEN DESIGNED TO BE FOUNDED IN A STABLE MATERIAL WITH A SAFE ALLOWABLE BEARING CAPACITY OF 100kPa. SHOULD CONDITIONS OTHER THAN THOSE DESCRIBED ABOVE BE ENCOUNTERED, THEN THE MATTER IS TO BE REFERRED TO THE ENGINEER FOR POSSIBLE RE-DESIGN.

STRUCTURAL TIMBER

- ALL WORKMANSHIP AND MATERIALS SHALL BE IN ACCORDANCE WITH AS1720 AND ALL OTHER RELEVANT CODES OF PRACTICE.
- ABNORMALLY GREEN OR SPLIT TIMBER SHALL BE REJECTED.
- TIMBER AT JOINTS SHALL BE FREE OF DEFECTS.
- UNLESS NOTED OTHERWISE, STRUCTURAL TIMBER SHALL BE MGP12 OF JOINT GROUP JD4 TIMBER OR BETTER.
- IT SHALL BE THE RESPONSIBILITY OF THE BUILDER TO ENSURE THAT TIMBER IS PROTECTED FROM THE WEATHER AND STRENGTH IS NOT IMPAIRED IN ANY WAY.
- THE TOLERANCE ON TIMBER ELEMENT DIMENSIONS SHALL BE -0;+3mm.
- ALL EXPOSED TIMBER SHALL BE OF DURABILITY CLASS 2 OR BETTER.
- ALL BOLTS, SCREWS AND NAILS TO BE GALVANISED AND INSTALLED IN ACCORDANCE WITH AS1720.
- ALL NAIL AND SCREW PENETRATIONS NOMINATED ARE TO BE INTO RECEIVING MEMBER.
- AL PLYWOOD IS TO BE STAMPED "PAA TESTED STRUCTURAL".
- ALL BOLTS IN TIMBER TO TIMBER BOLTED STRUCTURAL JOINTS SHALL BE PROVIDED WITH A WASHER AT EACH END IN ACCORDANCE WITH AS1720.
- ALL BOLTS IN CONTACT WITH CCA PRESERVATIVE TREATED TIMBER SHALL BE COATED IN GREASE OR OTHERWISE INSULATED FROM THE PRESERVATIVE TREATED TIMBER PRIOR TO ERECTION.
- WHERE NO OTHER DETAILS ARE GIVEN, WORK SHALL CONFORM TO AS1684.3 FOR THE SPECIFIED WIND SPEED.

CONCRETE

- ALL WORKMANSHIP AND MATERIAL SHALL BE IN ACCORDANCE WITH AS 3600 - 2001.
- MINIMUM COVER TO REINFORCEMENT TO BE AS FOLLOWS U.N.O ON THE DRAWINGS.
 

BORED PIER FOOTINGS	50mm
BORED PIER FOOTINGS	N20
- CONCRETE GRADE SHALL BE AS FOLLOWS:
 

BORED PIER FOOTINGS	N20
---------------------	-----
- REINFORCEMENT SYMBOLS:-
 

SL	HARD DRAWN STEEL WIRE REINFORCING FABRIC TO AS1304.
N	HOT ROLLED DEFORMED BARS TO AS1302.
R	STRUCTURAL GRADE PLAIN ROUND BAR TO AS 1302.
W	REINFORCED WIRE TO AS 1303.
- IF CONCRETE IS PLACED IN HOT AND/OR WINDY WEATHER (>28°C), AN ALIPHATIC FOG SPRAY IS RECOMMENDED TO REDUCE EVAPORATION.
- WELDING OR SITE BENDING OF REINFORCEMENT IS NOT PERMITTED WITHOUT APPROVAL FROM THE SUPERINTENDENT.
- SLAB SURFACE AND EXPOSED SIDES SHALL BE CURED FOR A PERIOD OF AT LEAST 7 DAYS BY AN APPROVED METHOD OF CURING. (MOIST CURING, SPRAYED MEMBRANE OR IMPERMEABLE PLASTIC).

STRUCTURAL STEEL

- ALL WORKMANSHIP AND MATERIAL SHALL BE IN ACCORDANCE WITH AS 4100, AS/NZS 4600, AS/NZS HB62 EXCEPT WHERE VARIED BY THE CONTRACT DOCUMENTS.
- UNLESS NOTED OTHERWISE, ALL STEEL SHALL BE:
  - GRADE 300 PLUS FOR HOT ROLLED SECTIONS
  - GRADE 300 PLUS FOR MERCHANT BAR (ROUND, SQUARE AND FLAT)
  - GRADE 250 FOR PLATES
  - GRADE C350 FOR RHS, SHS AND CHS
- UNLESS OTHERWISE SHOWN, ALL INTERFACES BETWEEN CONNECTING STEELWORK SHALL BE EITHER BOLTED OR CONTINUOUSLY WELDED. UNLESS OTHERWISE SHOWN, ALL WELDS SHALL BE 6mm FILLET WELDS ON BOTH SIDES, USING E48XX ELECTRODES. ALL WELDS SHALL BE CATEGORY SP.
- UNLESS OTHERWISE SHOWN, ALL BOLTS SHALL BE GALVANISED M20 8.8/S CONFORMING TO AS 1252, TIGHTENED TO A SNUG TIGHT FIT. ALL HOLDING DOWN BOLTS SHALL BE HOT-DIPPED GALVANISED, GRADE 4.6/S U.N.O.
- THE ENDS OF ALL TUBULAR MEMBERS SHALL BE SEALED WITH NOMINAL THICKNESS PLATES AND CONTINUOUS FILLET WELDED, UNLESS NOTED OTHERWISE.
- ALL HOT-DIPPED GALVANISED MEMBERS SHALL BE PROVIDED WITH VENT AND DRAINAGE HOLES IN ACCORDANCE WITH THE GALVANISER'S RECOMMENDATIONS. PATCH VISIBLE SURFACES AS INSTRUCTED BY THE ARCHITECT/SUPERINTENDENT.
- THE CONTRACTOR SHALL PROVIDE AND LEAVE IN PLACE, UNTIL PERMANENT BRACING ELEMENTS ARE CONSTRUCTED, SUCH TEMPORARY BRACING AS IS NECESSARY TO STABILISE THE STRUCTURE DURING ERECTION.
- ALL GUSSET AND END PLATES SHALL BE 10mm THICK U.N.C
- UNLESS OTHERWISE NOTED, ALL STRUCTURAL STEEL MEMBERS SHALL BE SAND BLASTED TO CLASS 2.5 AS 1627 PART 4-2005 AND PRIME-COATED WITH INORGANIC ZINC PRIMER (INTERNATIONAL INTERZINC No.7 TECHNICAL NOTE M106 OR EQUIVALENT). FINISHED DRY FILM THICKNESS SHALL BE NOT LESS THAN 75 MICRONS NOR GREATER THAN 100 MICRONS.
- COMMERCIAL GRADE BOLTS SHALL CONFORM TO AS/NZS 1111 AND AS 4100. HIGH STRENGTH STRUCTURAL BOLTS SHALL CONFORM TO AS/NZS 1252 AND AS 4100.

**ISSUED FOR CONSTRUCTION**

0	SAMPLE	SAMPLE			
Rev	Description	Designed	Approved	Date	

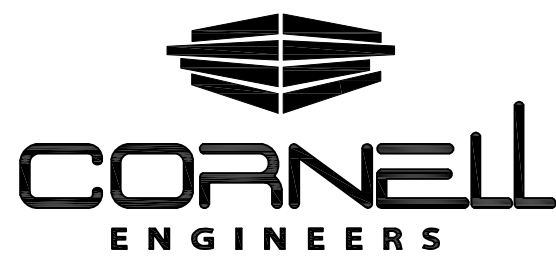

PO BOX 2572  
ASCOT QLD 4007

Project <b>SAMPLE DECK DRAWINGS</b>	Job No. SAMPLE	Scale NTS
Title PROJECT SPECIFIC NOTES	Drawing No. S1	Revision 010

SAMPLE FOR APPROVAL

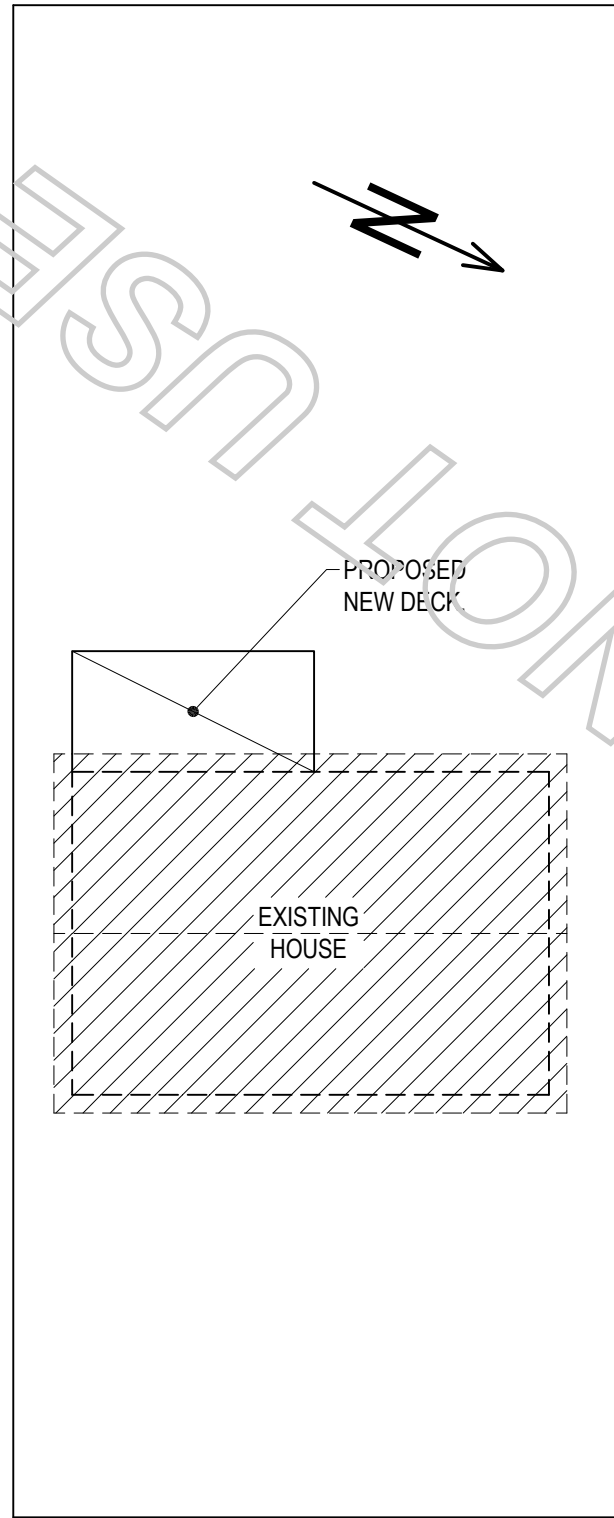

STREET NAME

**SITE PLAN**  
1:250

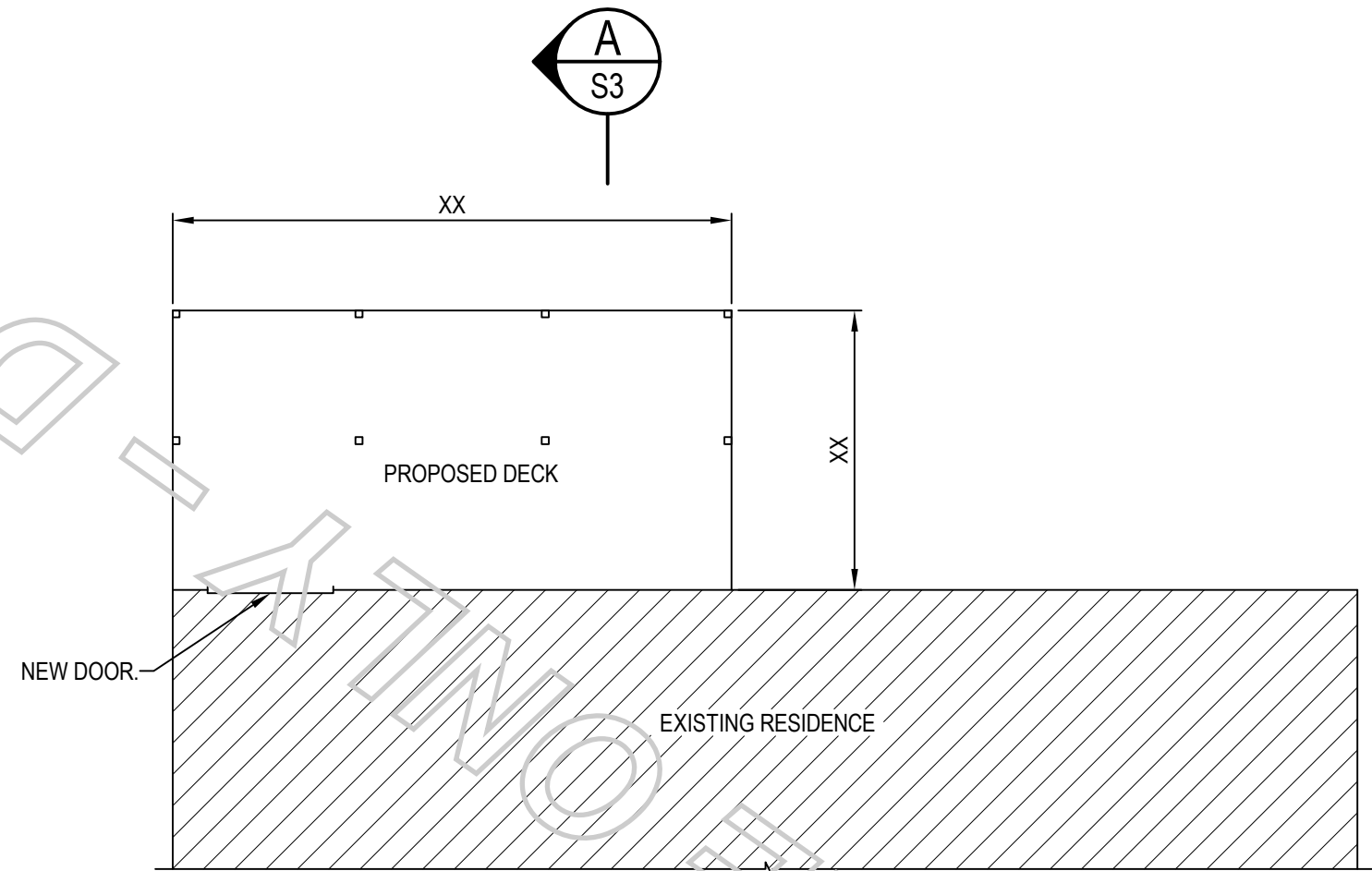

**FLOOR PLAN**  
1:100

**ISSUED FOR CONSTRUCTION**

Rev	Description	Designed	Approved	Date
0	SAMPLE	SAMPLE		

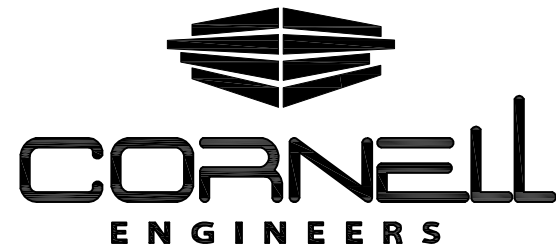

PO BOX 2572  
ASCOT QLD 4007

Project  
**SAMPLE DECK DRAWINGS**

Job No.  
**SAMPLE**

Scale  
**1:250; 1:100**

Title  
**SITE PLAN AND FLOOR PLAN**

Drawing No.  
**S2**

Revision  
**010**

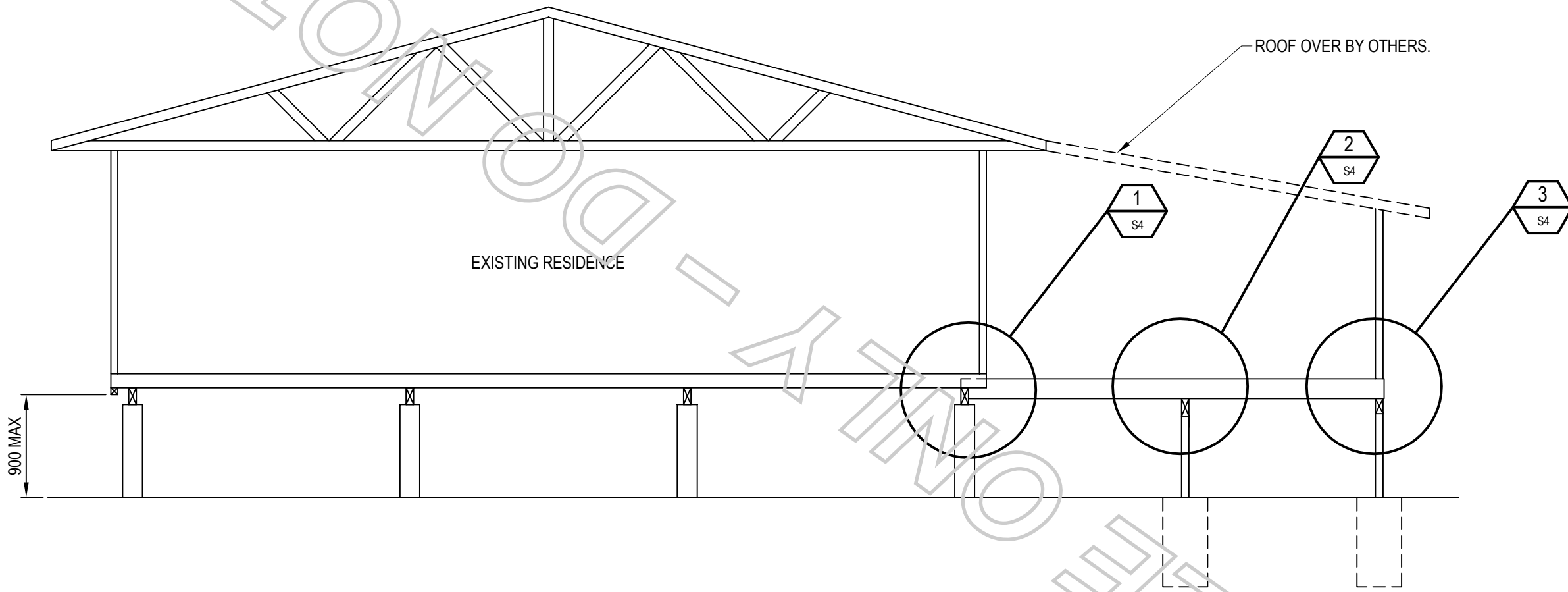

SECTION A  
1:50 S2

Rev	Description	Designed	Approved	Date
0	FOR CONSTRUCTION	SAMPLE		

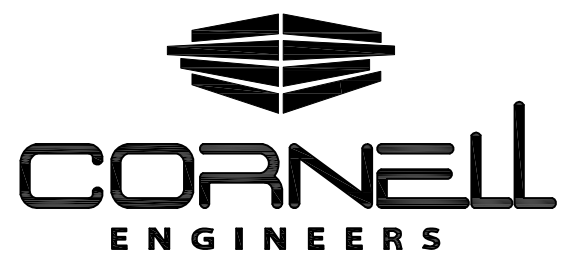

PO BOX 2572  
ASCOT QLD 4007

Project SAMPLE DECK DRAWINGS		Job No. SAMPLE	Scale 1:50
Title SECTION		Drawing No. S3	Revision 010

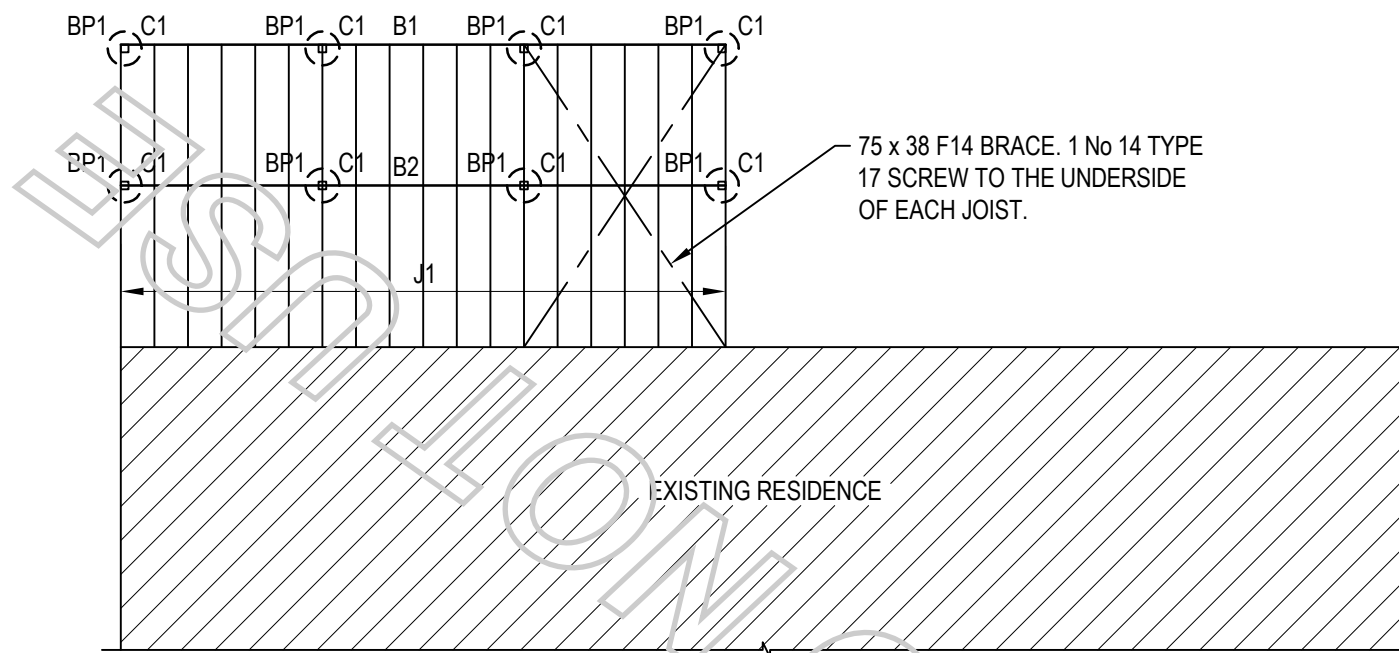

**FLOOR FRAMING PLAN**  
1:100

MEMBER SCHEDULE	
MARK	SIZE
B1	NEW HWD BEARER SIZE.
B2	NEW HWD BEARER SIZE.
BP1	NEW BORED PIER SIZE.
C1	NEW STEEL POST SIZE.
J1	NEW JOISTS AT 450 MAX CTS.

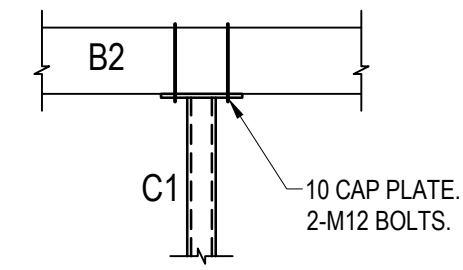

**BEARER TO POST DETAIL**  
1:20

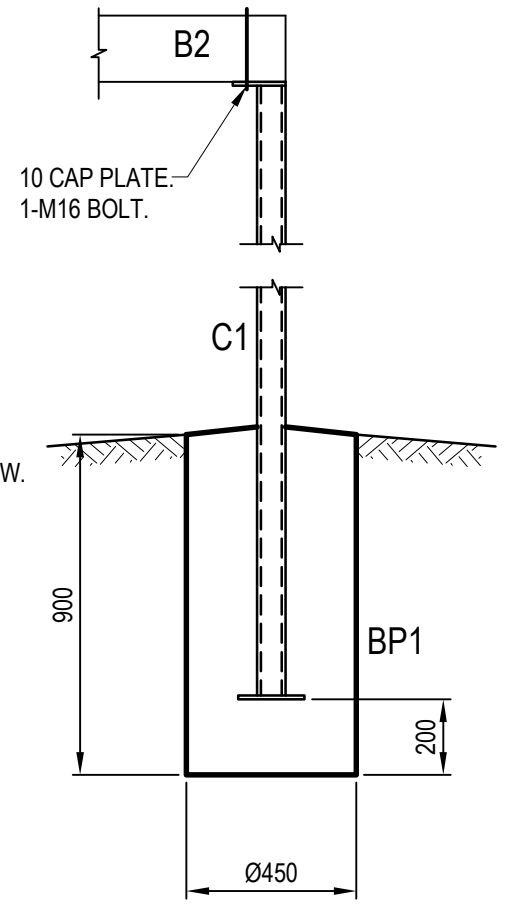

**BEARER TO POST TO BORED PIER DETAIL**  
1:20

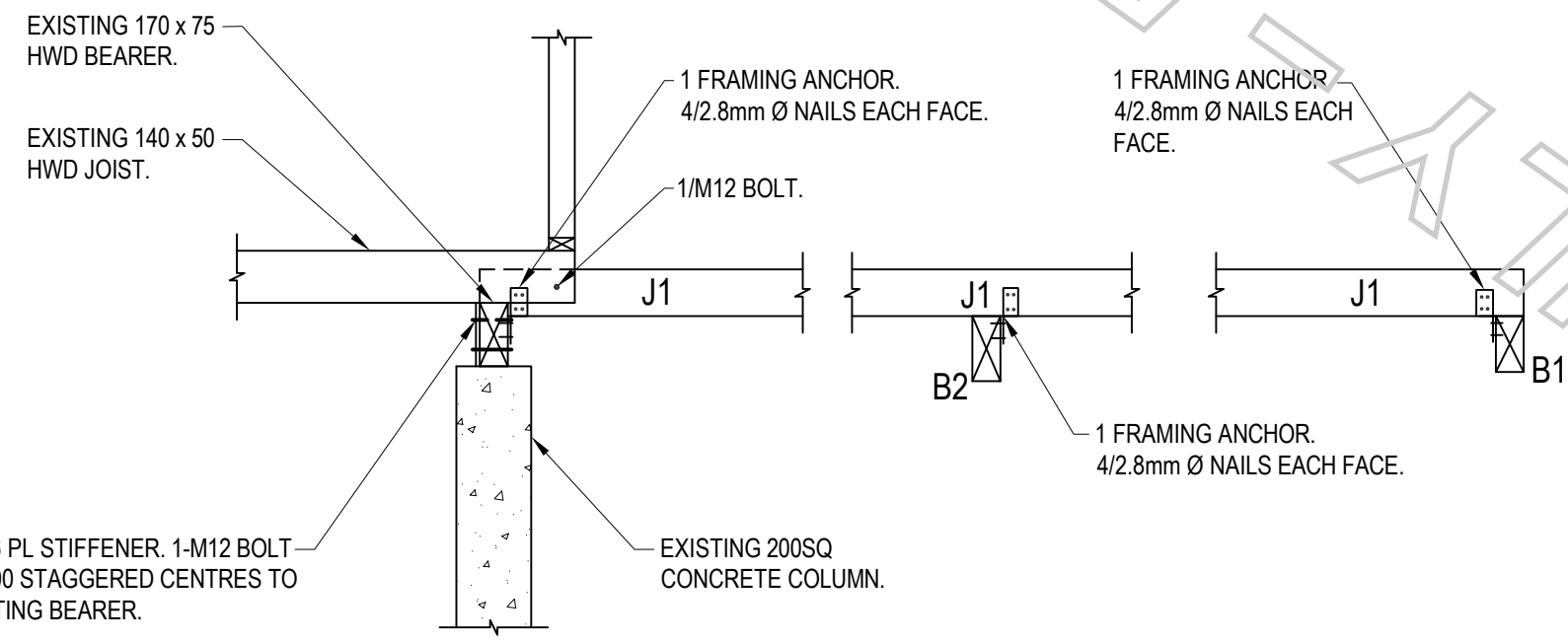

**DETAIL 1**  
1:20  
S3

**DETAIL 2**  
1:20  
S3

**DETAIL 3**  
1:20  
S3

Rev	Description	Designed	Approved	Date
0	SAMPLE DRAWING	SAMPLE		

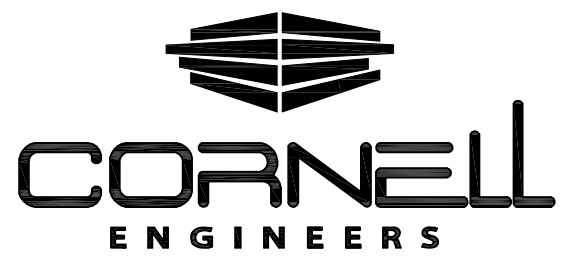

PO BOX 2572  
ASCOT QLD 4007

Project <b>SAMPLE DECK DRAWINGS</b>	Job No. <b>SAMPLE</b>	Scale <b>1:100; 1:20</b>
Title <b>FLOOR FRAMING PLAN AND DETAILS</b>	Drawing No. <b>S4</b>	Revision <b>010</b>